

Setup Guide

NWA-A09978-001-00
February, 2020

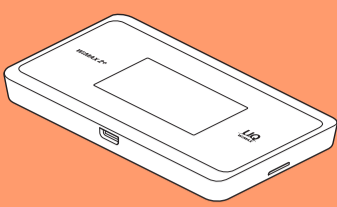

Read this to connect and configure the product

Speed Wi-Fi NEXT WX06

Technically Certified

Preface

Thank you for buying the Speed Wi-Fi NEXT WX06 (simply called the "product" from here on). Before using the product, be sure to read the "Setup Guide" (this manual) and the "Notes on usage" to ensure correct use.

List of Packaged Items

Before you start using the product, make sure that you have all the following items packaged with the product.

- Speed Wi-Fi NEXT WX06 main unit
- USB2.0 TypeC-A cable (GXE-004386) (sample)



- Battery pack (NAD34UAA)
- つなぎかたガイド "Setup Guide" (Japanese)
- Rear cover
- ご利用にあたっての注意事項 (保証書) "Notes on usage" (with warranty) (Japanese)

- Keep the packaged items, including the warranty, in a safe place.
- An AC adapter is not included. Purchase the specified charging equipment (sold separately). For details, see "Related Accessories" in "Notes on usage".
- The illustrations of the product used in this manual are simulated images. They may differ from the actual product.

About the Instruction Manual

- "Setup Guide" (this manual): Explains only the main functions, operations, and settings of the product.
- "取扱説明書 詳細版 (Full Instruction Manual)" (Japanese): Explains the various functions, operations, and settings of the product in detail.
- In this manual, the "Setup Guide" (this manual), "Notes on usage", and "取扱説明書 詳細版 (Full Instruction Manual)" (Japanese) are collectively referred to as the "Instruction Manual".
- A PDF version of the "取扱説明書 詳細版 (Full Instruction Manual)" (Japanese) is stored on the product. Connect the product to a PC or the like by means of wireless LAN (Wi-Fi) or a USB2.0 TypeC-A cable, launch the web browser, type "http://192.168.179.1" in the address field and log in to the Advanced Settings on Quick Setting Web to view [情報 (Information)], and access [マニュアル (Manual)].
- Refer to **STEP4** Changing the Initial Password" on the next page of this manual.
- The latest PDF versions of the "Instruction Manual" can be downloaded from the WiMAX Support Information website.
- https://www.necplatforms.co.jp/support/wimax/wx06/index.html (in Japanese only)

About the Notations in This Manual

- Notes on Illustrations / Screenshots
- The screenshots and methods of operation in this manual are those when an au Nano IC Card 04 LE U is inserted.
- The illustrations and screenshots in this manual are simplified and may look different from the actual product and screens. Also, a part of a screen may be omitted.
- This manual uses the display of the body color "Lime Green" to explain examples.
- In this manual, the "au Nano IC Card 04 LE U" is referred to as an "au IC card".
- In this manual, the "USB2.0 TypeC-A cable" provided in the package is referred to as a "USB cable".
- In this manual, the "WX06 cradle" is referred to as the "cradle".
- Company names and product names referred to in this manual are trademarks or registered trademarks of their respective companies. TM and the ® mark may be omitted in this manual.

Before using the product

The product can transmit data to a wireless base station by using the WiMAX 2+ system or the LTE system. You can select from the following communication modes to use this.

	WiMAX 2+	LTE
High Speed (HS)	○	—
High Speed Plus Area (HS+A)	○	○

- *If you move to an area in which communications using "High Speed (HS)" mode are not possible, the "Onetime HS+A" mode is available, which switches the mode to the "High Speed Plus Area (HS+A)" mode temporarily.
- *The default setting is "High Speed (HS)" mode. Note that an additional charge may be incurred, depending on your billing plan, when you switch to "High Speed Plus Area (HS+A)" mode.
- Regarding connecting the product to a smartphone or PC, or the like, refer to **STEP2** Connecting to Wireless LAN (Wi-Fi)*.

Part Names and Functions

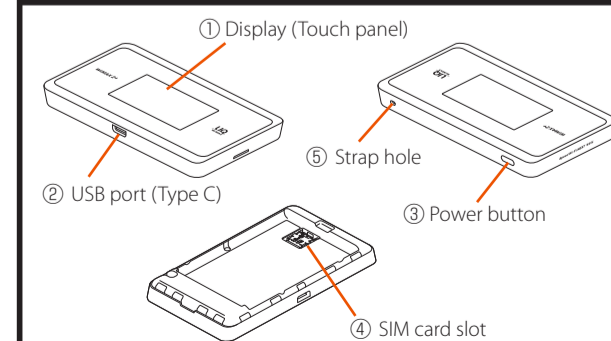

Name	Function
① Display (Touch panel)	Lets you view the status of this product and notification information. Main settings for the product can be done with the touch panel.
② USB port (Type C)	Used to connect the USB cable (sample) to the product, or when placing the product on the cradle (sold separately).
③ Power button	Turns the power on/off. Use to turn on/off the display. Use to put the product in an idle state, or to recover from idling or waiting.
④ SIM card slot	Insert the au IC card into this slot.
⑤ Strap hole	Used to attach a strap.

- The antenna is built-in. Covering the product with your hand during communication may affect the communication quality.

Downloading the "NEC WiMAX 2+ Tool" Application for Your Smartphone

By using "NEC WiMAX 2+ Tool", an application designed especially for this product, it is possible to view information about the product on your smartphone, etc. and perform operations to update the firmware or change to the idle state.

- * Operating this specialized application allows you to do remote activation. Search the Google Play Store or App Store for "NEC WiMAX 2+ Tool" to download and install this specialized application.

(As of February, 2020)

- * The "NEC WiMAX 2+ Tool" smartphone application has a Japanese user interface.
- * Settings cannot be done on this product with "NEC WiMAX 2+ Tool" while the product is being operated. In addition, operating the product while doing settings via "NEC WiMAX 2+ Tool" may interrupt the settings being done with "NEC WiMAX 2+ Tool". Leave the display showing the home screen.
- * You can use "NEC WiMAX 2+ Tool" to connect to a wireless LAN (Wi-Fi)*. (Refer to **STEP2** Using a Rakuraku QR Code to Connect to Wireless LAN (Wi-Fi)* on the next page.)

How to Use the Touch Panel

The display of this product is a touch panel. The product operates by detecting your finger's movements using a capacitive sensing method.

- Tap**
Lightly touch the touch panel, and then immediately remove your finger. If you tap too briefly, there may be no reaction.
- Slide**
When an entire screen cannot be displayed, lightly touch the touch panel and move it in the desired direction.
- To return to the home screen, tap the button.
- Use slide operations on the home screen and the screens to the left and right of the home screen. Use a tap operation to operate other screens.
- When the home screen is displayed, slide it to the left or right. Buttons for doing settings and checking information are displayed. *Refer to "Displayed Information" on the next page for the actual screenshots.
- To display the next screen in menus with many items (such as the "Settings" menu), tap the button. (To return to the previous screen, tap the button.)
- To move screens up or down, tap the buttons.

Preparing for Setup

Inserting the au IC Card (SIM Card)

When inserting the au IC Card, be sure to disconnect the product from the power source and turn off the power to the product. Remove the USB cable (sample) and cradle (sold separately) if they are connected.

- Your telephone number and other details are stored on the au IC card, however, the product cannot be used to make or receive voice telephone calls, etc.
- This product supports au Nano IC Card 04 LE U.
- Data communication via a Wide Area Network (WAN) cannot be done if the au IC card is not inserted.
- Be careful not to touch or damage the IC (metal) part of the au IC card.

- Slide the top clasp (cover) of the SIM card slot in the direction of the arrow to release the lock.
 - * Do not press on the clasp from above.
- Lift up the clasp (cover) of the SIM card slot in the direction of the arrow. Insert the au IC card, so the IC (metal) part is facing forward and the notch is to the upper right, directly into the rails of the SIM card slot.
 - * Be careful of the orientation of the notch.
 - * Confirm the correct inserting direction of the IC card. Failure to do so might cause a malfunction or damage.
 - * Refrain from inserting an SD card or IC card with a conversion adapter. Doing so might cause failures.

- Push the SIM card slot down, and lock it by sliding it in the direction of the arrow, while lightly pressing the top of the clasp (cover), until you hear a click.
 - * Do not place the au IC card directly on the connectors in the bottom of the SIM card slot. Doing so might cause a malfunction or damage.
 - * Do not insert or push the IC card forcefully. Doing so might cause a malfunction or damage. If something feels strange, return the SIM card slot temporarily and lock it again.
 - * An error message is displayed if the au IC card is not properly inserted, or if there is an abnormality with the au IC card.
 - * Be careful not to lose the au IC card after you remove it.

- You can confirm the product's device information (Phone Number, ICCID, etc.) on its display. <How to confirm>: Slide the home screen to the left and tap [Information] - [Device Information]

Preparing for Setup (Continued)

Attaching the Battery Pack

- Slide the battery pack, with the marked surface (recycling symbol, etc.) facing up, all the way in. Align the product's terminals and the battery pack's terminals, and then insert it in the direction of ①, and then insert it in the direction of ②.
 - * Use the battery pack specified for this product.

<Removing the battery pack>
Lift up the front part of the battery pack and pull it out in the direction of ② to remove it.

- Attach the rear cover.
Confirm the position of the hooks inside the rear cover and place it so that they align with the product. While firmly pressing the parts in the following illustration, attach the rear cover so that there are no gaps.
 - Press the parts firmly and securely to attach the rear cover.
 - Align the tabs on this side first.
 - Notch side
 - Power button

Charging the Product

This section explains how to charge the product using the specified TypeC Common AC Adapter 01 U (0601PQV) (sold separately).

- The battery pack is not fully charged at the time of purchase. Be sure to charge the battery before using the product.
- We recommend charging this product while the power is off or while it is idling.
- If the power is on, or if the temperature of the product or battery pack is high, charging may stop, even if the battery is not full, in order to maintain the battery's life. Also, if you continue charging it for a long time while the power is on, the battery enters the "Long Life Charge" state (the maximum charge capacity is about 70%) and the remaining battery power is automatically reduced gradually to protect the battery.
- The charging time varies depending on the environment and conditions in which the product is used. Fast charging is possible if you are using a TypeC Common AC Adapter 01 U (0601PQV) (sold separately). For the time it takes to charge, refer to the "Product Specifications" section on the next page.

- Plug the power plug of the AC adapter (sold separately) into a power outlet.
 - * Make sure that the AC adapter (sold separately) does not come unplugged.
- Insert the USB connector (Type C) of the AC adapter (sold separately) into the USB port (Type C) on the product.
 - Plug the USB connector (Type C) straight into the USB port (Type C) of the product.
 - Pressing the Power button when charging with the power off or while idling shows how much of the battery has been charged (%).
 - Because the battery pack is initializing when being used for the first time after attaching it, showing how much of the battery has been charged may take some time.
 - If you turn on "Long Life Charge", charging stops when the battery's level is about 70%. Repeatedly charging and discharging the battery pack frequently while it has sufficient remaining power prevents accelerated deterioration of the battery pack. (Default setting: OFF)
 - Display procedure: Slide the home screen to the right and tap [Quick Menu] - [ECO] - [Long Life Charge].

For information on how to charge the battery pack on the cradle (sold separately), refer to the "WX06 クレードル (NAD36PUU) 取扱説明書 (Instruction Manual of the cradle)" (Japanese).

Turning the Power On

- Hold down the Power button until "NEC" is displayed in the display and the product is turned on. (The remaining battery level appears while "NEC" is displayed immediately after you install a battery pack and when you turn on the power after the power was fully off.)
 - * When the home screen (refer to "Displayed Information" on the next page) is displayed, proceed to **STEP2**.



Switching to English display

From the home screen, tap [設定 (Settings)] - [メンテナンス (Maintenance)] - [言語設定 (Language)] - [English].

3 Read the guidelines for the "Notes on usage" by tapping the button to move to the bottom, and then tap [YES]. (If you select [NO], "Wi-Fi Management Frame" remains on.)

4 Read the guidelines for the "Favor on usage" by tapping the button to move to the bottom, and if you agree, tap [YES]. (If you select [NO], the quality information collection function remains off.)

5 When "Do you want to start Setup Wizard?" is displayed, continue to **STEP2** by tapping [YES].

- In step 5, when you select [NO], or after connecting Wi-Fi* in **STEP2** by using the WPS function or by manual settings, you should then tap the button to read to the bottom of "Do you set Wi-Fi (2.4GHz/5GHz) both ON?", and then tap [YES] or [NO]. (If you selected [YES], tap [YES] in "Notice for using 5GHz band Wi-Fi", and then select [Indoor] or [Outdoor] in the "5GHz Freq Settings" screen). For details, see "About the Wi-Fi 2.4 GHz/5 GHz Simultaneous Usage (Band Steering) Function" on the next page of this manual.

Connecting to Wireless LAN (Wi-Fi)

Data communication can be performed with this product by connecting wireless LAN (Wi-Fi)* devices such as a PC, game console, smartphone, etc. Up to 16 wireless LAN (Wi-Fi)* devices can be connected to this product. However, depending on the ambient reception environment, the number of connected devices may not reach the limit.

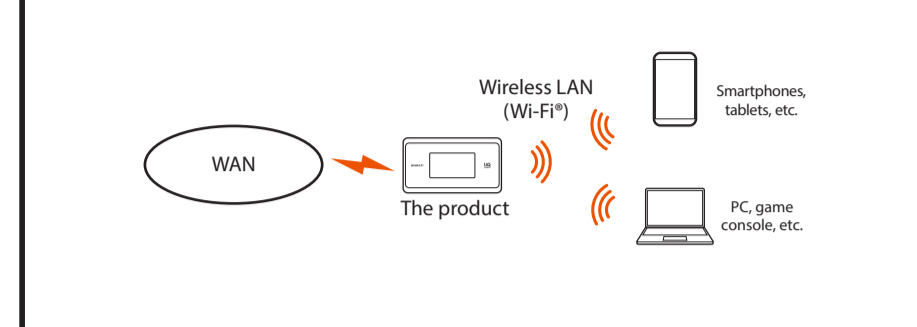

- There are five connection methods, as shown below. Connect using one of these methods.
- Copy the settings of the router that the product has used until now (Wireless LAN (Wi-Fi)* device settings do not need to be changed)
 - Separately set connections for each wireless LAN (Wi-Fi)* device (b) WPS function
 - Wi-Fi Settings Moving (a) Wi-Fi Settings Moving (c) Manual connection
 - Wi-Fi QR Code (d) Wi-Fi QR Code
 - Rakuraku QR Code (e) Rakuraku QR Code

Types of wireless LAN (Wi-Fi)* devices (examples)	(b) WPS function	(c) Manual connection	(d) Wi-Fi QR Code	(e) Rakuraku QR Code
Smartphones/tablets (Android devices)	○*1	○	○*	○
iPad (iPadOS devices)/iPhone/iPod touch (iOS devices)	—	○	○*	○
PC (Windows OS)/game consoles	○	—	—	—
PC (macOS)	—	○	—	—

- *1 WPS is not supported on some Android versions
- *2 Supported on Android 10 and later
- *3 Supported on iOS 11.0 and later, and iPadOS 13.0 and later

(a) Using the Wi-Fi Settings Moving Function

* You can also slide the home screen to the right, and tap [Settings] - [Easy Wireless Settings] - [Wi-Fi Settings Moving] to show a guidance screen.

* The router you have used in the past needs to have supported WPS. In addition, some of the wireless LAN (Wi-Fi)* settings may not carry over, depending on the functions and settings (such as unusable text or encryption mode) of the router you were using in the past.

Start up the WPS function of the router you were using previously. (Refer to the user manual for the router you are using for the method to start up the WPS function.)

Next, when connecting to wireless LAN (Wi-Fi)*, tap [YES] in the settings confirmation screen for the Wi-Fi device.

You can confirm if the "SSID" is the SSID of the router you have used until now, by sliding the home screen to the left, and tapping [Information] - [Wi-Fi Information].

You can redo the Setup Wizard by sliding the home screen to the right, and tapping [Settings] - [Easy Wireless Settings] - [Setup Wizard].

(b) Use the WPS Function to Connect to Wireless LAN (Wi-Fi)*

If the wireless LAN (Wi-Fi)* device supports the push-button format of the WPS function, you can easily do the setup without having to input the SSID, security methods and other settings needed to connect.

1 After the product's SSID is displayed, set your wireless LAN (Wi-Fi)* device. The following is explained using Windows 10 as an example.

2 Turn on the power to your PC, and then enable the wireless LAN (Wi-Fi)* function. * Refer to the user manual, etc., for your PC for how to connect.

3 From your PC's network (Wi-Fi)* screen, select the network name (SSID) that was displayed in step 1, select "自動的に接続 (Connect automatically)", and then click [接続 (Connect)].

4 When "Please tap the Next button after starting WPS. SSID : SPWN_N36_XXXXX" appears on the display of the product, tap [Next].

5 If "If you tap WPS button, then setup starts" is displayed, tap [WPS]. A little while after "WPS is in progress..." is displayed, "Connection succeeded" is displayed. Tap [Exit].

If the product cannot connect to the PC, "Connection failed" is displayed. Check that the PC's wireless LAN (Wi-Fi)* function is enabled, and then retry from step 1.

(c) Manual Settings for Wireless LAN (Wi-Fi)* Connections

This section explains how to connect to wireless LAN (Wi-Fi)* using a macOS computer as an example.

- Slide the home screen of the product to the right. When [Settings] - [Easy Wireless Settings] - [Setup Wizard] - "Do you want to start Setup Wizard?" (screen from **STEP1**) appear, tap [YES]. In the guidance screen for the Wi-Fi Settings Moving function, tap [NO]. In the settings confirmation screen, tap [YES]. In the confirmation screen, tap [Next]. Tap [Manual connection].
- Turn on the power to your PC, and then enable the wireless LAN (Wi-Fi)* function * Refer to the user manual, etc., for your PC for how to connect.
- On the Apple menu, click the システム環境設定 (System Configuration) - [ネットワーク (Network)] icon and select [Wi-Fi] from the service list.
- From the [ネットワーク名 (Network Name)] pulldown menu, select the SSID of the product, "SPWN_N36_XXXXX", that was displayed in 1.
- Enter the encryption key (password) for the product in [パスワード (Password)], and then click [接続 (Connect)]. * This example screen is from a macOS v.10.14.
- If [接続済み (Connected)] is displayed in [状況 (Status)], tap [Next] on the product.
- When "Setup Wizard will finish." appears on the display of the product, tap [OK].

STEP 2 Connecting to Wireless LAN (Wi-Fi*) (continued)

(d) Using a Wi-Fi QR Code to Connect to Wireless LAN (Wi-Fi*)

- Supported iOS versions: 11.0 and later
- Supported iPadOS versions: 13.0 and later
- Supported Android versions: 10 and later

This section explains how to connect to wireless LAN (Wi-Fi*) using an iOS/iPadOS device as an example.

1 Open the camera in your iOS/iPadOS device, in the Camera View screen, read the "QR Code for Wi-Fi Settings" in the product's display.

* How to display it on the product: Slide the home screen to the right, and tap [Settings] - [Easy Wireless Settings] - [Wi-Fi QR Code], and then read the confirmation screen to the bottom, and tap [YES] to display the QR Code.

2 Tap "Wi-Fi QR CODE Join "SPWN_N36_XXXXX" Network", which is displayed in the upper part of the Camera View screen on your iOS/iPadOS device, and then tap [Connect] in the confirmation screen that appears.

- For Android devices that are version 10 and later, tap "SPWN_N36_XXXXX", which is displayed in the lower part of the Camera View screen, and then confirm that the product appears as "接続済み (Connected)" in the Wi-Fi screen.

• For iOS/iPadOS devices, if you tried connecting manually with an SSID connected using a Wi-Fi QR Code (if you selected the product's SSID from "Select Network", then you may need to re-input the encryption key.

• If you previously registered the same SSID settings to an Android device, the Android device settings are not updated.

(e) Using a Rakuru QR Code to Connect to Wireless LAN (Wi-Fi*)

This procedure uses the smartphone application "NEC WiMAX 2+ Tool" to connect to wireless LAN (Wi-Fi*).

*The "NEC WiMAX 2+ Tool" smartphone application has a Japanese user interface.

1 Open "NEC WiMAX 2+ Tool".

2 In the main screen of the "NEC WiMAX 2+ Tool", tap [Wi-Fi設定].

3 Tap [パスワードの設定 (Password Settings)].

4 Slide the home screen of the product to the left and tap [Information] - [Device Information] to confirm the "Administrator initial password".

• After confirming, return to the home screen.

5 In "NEC WiMAX 2+ Tool", enter the administrator initial password for the product, and then tap [保存 (Save)].

6 Tap [Wi-Fi設定 (Wi-Fi Settings)].

7 In the Wi-Fi settings screen, tap [OK].

8 In the Camera View screen, read the "QR Code for Wi-Fi Settings" from the product's display.

• How to display it on the product: Slide the home screen to the right, and tap [Settings] - [Easy Wireless Settings] - [Rakuru QR], and then read the confirmation screen to the bottom, and tap [YES] to display the QR Code.

• After reading the QR Code, return to the home screen.

9 Next, tap [設定適用 (Apply)] on the screen, and then tap [OK] in the confirmation screen.

STEP 3 Verifying the Connection Status

◆ If **HS** is displayed along with **lit** in the display and the product can be connected to the internet, the settings are complete.

◆ If **HS-A** is displayed along with **lit** in the display and the product cannot be connected to the internet, configure the connection destination in **POINT 1**.

◆ If the wireless LAN (Wi-Fi*) connection with the product is not established, slide the home screen to the right, go to [Settings] - [LAN Settings] and uncheck "Wi-Fi Management Frame", and then redo the wireless LAN (Wi-Fi*) connection as in **STEP 2**.

◆ If "Please check APN settings" is displayed, configure the connection destination in **POINT 1**.

◆ Confirm that this product has the latest firmware. (How to confirm: Slide the home screen to the right, [Settings] - [Maintenance] - [Firmware Update])

The version of this product is confirmed via the display. (How to confirm: Slide the home screen to the left - [Information] - [Device Information] - [Firmware Version])

When "There is new firmware available. Do you want to update?" is displayed on the display of this product, it indicates that a new firmware exists.

STEP 4 Changing the Initial Password

Default Settings in Quick Setting Web

To ensure security, change the initial password (administrator password and encryption key) that had been set at time of purchase.

Administrator Password	Password you are requested to input to log in to Advanced Settings Top on the Quick Setting Web and to use the "NEC WiMAX 2+ Tool" application for your smartphone
Encryption Key (Password)	Password to use with SSID when connecting to wireless LAN (Wi-Fi*)

(Defaults: Slide the home screen to the left and tap [Information] - [Device Information] for the "Administrator initial password", and tap [Wi-Fi Information] for "Password".)

1 Open the web browser on the wireless LAN (Wi-Fi*) device (such as a smartphone) connected to the product in **STEP 2**.

2 Return the product to the home screen or press the Power button to turn off the display.

Settings cannot be done to the product using Quick Setting Web while the display is on. Additionally, operating this product's display while doing settings on Quick Setting Web may interrupt the settings being done via Quick Setting Web.

3 Open Quick Setting Web for the product. Type "http://192.168.179.1" into the address bar in the web browser and either tap [実行 (Execute)] or [開く (Open)], or press the Enter key on the keyboard.

4 Tap or click [Advanced Settings Top] in the Quick Setting Web screen.

5 Enter "admin" for the [Username] or "ユーザー名 (Username)" and enter the "administrator password" displayed in Device Information for "パスワード (Password)", and then tap [Sign in] or click [OK].

6 Change the administrator password. Enter the current administrator password in the "初期パスワード (Initial Password)" field, and enter the new administrator password (*) in the "新しいパスワード (New Password)" and "新しいパスワード再入力 (Re-Enter)" fields, and tap or click [変更 (Set)].

- Numbers 0-9, letters a-z and A-Z, hyphens (-) and underscores (_) may be used in the password. A password may be up to 64 single-byte characters.

This password will be required every time you open "Quick Setting Web" for the product. Make sure that you do not lose this password.

7 Change the encryption key (password). Use the following procedure to enter a new encryption key, and then tap or click [Apply].

- Procedure to change (2.4 GHz and 5 GHz): [Wi-Fi Settings] - [Wi-Fi Settings] - "Encryption" - "WPA Encryption Key (PSK)"
- *For WPA, enter 8 to 63 alphanumeric digits (0-9, a-z, A-Z, and symbols), or enter 64 hexadecimal digits (0-9, a-f, A-F)
- Procedure to change (guest SSID): [Wi-Fi Settings] - [Wi-Fi Settings (Guest SSID)] - "Encryption" - "Encryption Key (WEP Key)"
- *For WEP, enter 13 alphanumeric digits 0-9, a-z, A-Z

* Make a note of the changed encryption keys, so you do not forget them.

Encryption Key Memo:

SSID

Guest SSID

* Write it down in the location described in the enclosed "つながりガイド" Setup Guide" (Japanese).

8 The Wi-Fi* connection is cut off, so refer to **STEP 2** Connecting to Wireless LAN (Wi-Fi*) on the previous page and connect to Wireless LAN (Wi-Fi*) again.

* When doing the manual connection procedure, use the encryption key (password) you changed in step 7.

9 Tap or click [Sign in] or [OK].

10 Tap or click [OK].

POINT 1 Configuring the Connection Destination Connecting Wide Area Network (WAN)

Configuring the Connection Information

◆ Connecting to Wide Area Network (WAN)

<When selecting a preset profile>

If the WiMAX operator to whom you are subscribed specifies a preset profile, slide the home screen to the right, and select the profile in [Settings] - [Network] - [APN]. If no profile is specified, you can use the profile (profile name "Internet") preset on the product to connect to the internet.

<When creating a new profile>

Follow the procedures below to add a profile when you are creating a new profile or when information required for internet connection (user name, password etc.) is specified by the WiMAX operator to whom you are subscribed.

- Launch a web browser, and open the product's Quick Setting Web (refer to **STEP 4**), and then tap or click [ネットワーク設定 (Network Settings)] - [プロフィール設定 (Profile Settings)].
- After selecting [no setup] in the "プロフィールリスト (Profile List)", tap or click [選択 (select)], enter the setup information such as the APN of the WiMAX operator to whom you are subscribed, and tap or click [設定 (Apply)].
- Tap or click [ネットワーク設定 (Network Settings)] - [接続設定 (Connection Settings)].
- In the "プロフィール選択 (Profile Selection)", select the profile which you set in step 2, and tap or click [設定 (Apply)].

Open a website to verify the connection.

Useful Product Functions

About the Reception Level Indicator

The indicator for receive levels is displayed in 13 levels in the display.

- The state of receive levels are displayed for the previous 20 seconds to the present, so you can confirm signal stability.
- The display does not turn off automatically while indicator for receive levels is being displayed.

<How to confirm>: Slide the home screen to the right and tap [Quick Menu] - [Indicator].

Shows the transition in receive levels for the last 20 seconds (Transitions to the left side of the screen)

Shows current receive level (Higher indicates a stronger signal)

About the Collective Settings

You can change the settings recommended for how you want to use the product with a single touch from the product's display. Slide the home screen to the right, and do the settings in [Collective Settings].

Menu	Overview of settings
Prioritize High Speed	Sets the product to maximum communication speed.
Standard Setting	Sets the product to a good balance of communication speed and continuous operating time.
Prioritize Save Batt	Sets the product to save energy to extend the continuous operating time by controlling the communication speed, signal transmission output, and display settings.
Not Use/Set each	You can turn off the Collective Settings function and set "Energy-Saving Mode" and "Brightness Adjustment" separately. (Saves the product's settings as they are before being turned off)

Select a menu and tap [YES].

* When using Collective Settings, specific settings cannot be changed. Furthermore, the communication speed and the transmission output of the wireless LAN (Wi-Fi*) may change and reconnections may happen.

About the Wi-Fi 2.4 GHz/5 GHz Simultaneous Usage (Band Steering) Function

This function automatically switches bandwidths to connected devices between 2.4GHz and 5GHz, as appropriate, according to signal conditions, such as the signal strength of the wireless LAN (Wi-Fi*) devices. This helps to maintain optimal high-speed transmissions.

<How to operate>: Slide the home screen to the right and tap [Quick Menu] - [Wi-Fi Frequency Band Settings] - [2.4G/5G both], and then select [Outdoor] or [Indoor] (default setting: [2.4G, 5G either], 2.4 GHz)

- Status icons display: 2.4G/5G both [Outdoor] is set: **lit**
- When 2.4G/5G both [Indoor] is set: **lit**

* Some wireless LAN (Wi-Fi*) devices do not switch bandwidths.

About 見えて安心ネット (Miete Anshin Net)

You can view a list of wireless LAN (Wi-Fi*) devices that have connected to the product, and block unknown devices from connecting to the product.

- Shows the connection status of wireless LAN (Wi-Fi*) devices that have connected to the product
- Manage which specified wireless LAN (Wi-Fi*) devices are allowed or not allowed to connect to the product
- Limit the time periods that specified wireless LAN (Wi-Fi*) devices are allowed to connect to the product

To use "見えて安心ネット (Miete Anshin Net)", tap [見えて安心ネット (Miete Anshin Net)] in the Advanced Settings Top screen in Quick Setting Web.

Displayed Information

Name	Indicator	State	Explanation
1 Reception level	lit	Lit	Indicates the signal strength of Wide Area Network (WAN) in 4 levels
2 Connection status	HS	Lit	Indicates that the product is out of the service area
	HS-A	Lit	Indicates that the product is connected to the internet in "High Speed (HS) mode"
	HS-A	Lit (green)	Indicates that the product is connected to the internet in "High Speed Plus Area (HS+A) mode"
	AP	Lit	Indicates that the product is connected to the internet in "Onetime HS+A mode"
3 Firmware update notification	lit	Lit (green)*	Indicates that new firmware has been released and an update is required
4 Status of wired connection	lit	Lit	Indicates that LAN is connected via USB
5 Status of guest SSID	lit	Lit	Indicates that the product is connected to the cradle (sold separately) and wired LAN
	lit	Off	Indicates guest SSID* is on
6 Wireless LAN (Wi-Fi*) band	lit	Lit	Indicates that the product is connected to the 2.4GHz band (the number on the lower right indicates the number of connected devices)
	lit	Lit	Indicates that the product is connected to the 5GHz band (outdoors) (the number on the lower right indicates the number of connected devices)
	lit	Blinking	Indicates that the product is confirming the channel that is in use (doing DFS check)
	lit	Lit	Indicates that the product is connected to the 5GHz band (indoors) (the number on the lower right indicates the number of connected devices)
	lit	Lit	Indicates that the product is connected to the 2.4G/5G both (Outdoor) Wi-Fi frequency setting (the number on the lower right indicates the number of connected devices)
	lit	Blinking	Indicates that the product is connected to the 2.4G/5G both (Outdoor) Wi-Fi frequency setting, and is confirming the 5GHz band being used
7 Schedule	lit	Lit	Indicates that the Schedule function is set
	lit	Lit (orange)	Indicates that the Schedule function is set and there is less than 10 minutes to power off
8 Energy-Saving mode	lit	Lit (green)	Indicates that the product is running in Eco mode (ECO (Battery))
	lit	Lit (green)	Indicates that the product is saving energy when the remaining battery level is low in Normal mode (NORMAL (Balanced))
	lit	Lit	Indicates that the product is running in Normal mode (NORMAL (Balanced))
	lit	Lit	Indicates that the product is running in High Performance mode (Hi-P (Speed))
	lit	Lit*	Indicates the remaining battery level on a scale of 6 levels
	lit	Lit*	Indicates that the battery is being charged
9 Battery status	lit	Lit*	Indicates the current data usage (3-day and 1-month accumulated data usage value) / upper limit set value
10 Displaying data usage	lit	Lit*	The length of the bar indicates the proportion used

*1: An additional charge, depending on your billing plan, may be incurred when you switch to using "High Speed Plus Area (HS+A) mode" or "Onetime HS+A" mode.

*2: The "Cloud White" body color has an orange display instead of a green one.

*3: You can use a guest SSID to create a temporary internet environment, such as for guests to use. Also, for some game, or other devices, "WEP" is supported as an encryption key.

*4: Turns green (lit) when "Long Life Charge" is on.

*5: The one month transmission volume counts communications in "High Speed Plus Area (HS+A) mode" and "Onetime HS+A" mode. You can change the modes whose transmission volumes are counted.

Initialization Method

When the product is not operating properly, or to bring back the default settings, perform initialization by following the steps below. (This will delete all user settings and the screen display will change to Japanese.)

- Slide the home screen to the right, and tap [Settings] - [Maintenance] - [Initialize].
- Once the message "Restoring to the initial settings. Do you want to initialize this device?" is displayed on the product's display, tap [YES].
- Initialization will be completed once the product has been reactivated.

* The firmware updates that you have installed are not changed by initializing the product.

Troubleshooting

If you experience difficulty setting up an internet connection even when the instructions in the "Setup Guide" and the "取扱説明書 詳細版 (Full Instruction Manual)" (Japanese) are followed, please check the following items.

Problem	Solution
Unable to connect to the internet	<ul style="list-style-type: none">Make sure that you are located in a service area.The incoming signal strength may be low. Retry the connection in a location with a higher incoming signal strength.If the "HS" or "HS+A" icon does not appear in the display, launch Quick Setting Web to check that an internet connection has been properly set up.
Communication is easily disrupted	<ul style="list-style-type: none">The incoming signal strength may be low. Check the radio reception level and move to a location for a higher incoming signal strength.Check the remaining battery level. If the remaining battery level is low, recharge the battery pack before reconnecting the product.Check to see if the product is properly connected to a PC, or the like, on a wireless LAN (Wi-Fi), or by a USB cable.If a battery is connected to a PC, or the like, on a wireless LAN (Wi-Fi) reboot the product.If there is radio interference from other networks, such as multiple access points having been set up in the vicinity, radio reception may be improved by changing "Channels" for the product.Confirm that this product has the latest firmware.
Communication seems slow	<ul style="list-style-type: none">The connection point might be congested. Allow for some time before retrying.When "There is new firmware available. Do you want to update?" is displayed on the display of this product, it indicates that a new firmware exists.
The charge in the battery seems to decrease quickly.	<ul style="list-style-type: none">When the Energy-Saving Mode is set to "Hi-P (Speed)", change it to "ECO (Battery)" mode.The battery is consumed more quickly while using the Band Steering function. Change the "Wi-Fi Frequency Band Settings" to "2.4G, 5G either".
Cannot connect to wireless LAN (Wi-Fi*)	<ul style="list-style-type: none">Slide the home screen to the right, set [Settings] - [LAN Settings] - [Wi-Fi Management Frame] to [OFF], and then you may be able to connect.

Product Specifications

Item	Specifications
Main Unit	<ul style="list-style-type: none">Physical dimensions (W x H x D) Approx. 111 (W) x 62 (H) x 13.3 (D) mmWeight Approx. 127 g (Battery pack attached)Interface USB connector (USB 2.0/Type-C) x 1** (Compliant with Bluetooth 4.0 Wireless Technology**)Display Color LCD (220 x 169 dots)Power supply AC adapter 100 to 240 VAC ± 10%, 50/60 HzBattery pack Lithium-ion, 3.8 V, 3,200 mAhContinuous standby time*1 Waiting state: Approx. 45 hours Idle state: Approx. 720 hoursContinuous communication time** *1 Collective Settings (Standard Setting)/ NORMAL (Balanced) Approx. 690 minutes High Speed (HS) mode: During Wi-Fi* connection Collective Settings (Prioritize High Speed)/ Hi-P (Speed) Approx. 500 minutes Collective Settings (Prioritize Save Batt)/ ECO (Battery) Approx. 840 minutesContinuous communication time** *2 Collective Settings (Standard Setting)/ NORMAL (Balanced) Approx. 630 minutes High Speed Plus Area (HS+A) mode: During Wi-Fi* connection Collective Settings (Prioritize High Speed)/ Hi-P (Speed) Approx. 490 minutes Collective Settings (Prioritize Save Batt)/ ECO (Battery) Approx. 800 minutesOperating environment Operating temperature range: 5°C to 35°C Operating humidity range: 35% to 85% (with no condensation)Charging time Approx. 160 minutes (when using the Type-C Common AC Adapter G1 U (601PQV) (sold separately))
LAN	<ul style="list-style-type: none">Communication methods WiMAX 2+, LTECommunication methods Wi-Fi* (compliant with IEEE802.11a/b/g/n/ac)Supported frequencies Wi-Fi*: 2.4 GHz/5 GHzWi-Fi security methods WEP (128 bit) WPA2-PSK (AES) WPA / WPA2-PSK (TKIP/AES)Maximum number of simultaneous connections Wi-Fi*: 16 devices/USB: 1 device
USB2.0 Type-C cable (sample)	<ul style="list-style-type: none">Length Approx. 1.0 mWeight Approx. 23 gInterface USB 2.0 Type A, USB 2.0 Type C

*1: The continuous standby time and continuous communication time may vary depending on the communication network being used.

2: The continuous communication time when connected to a single wireless LAN (Wi-Fi) device.

** Use of USB 2.0 or later is recommended as a sufficient transfer rate cannot be achieved with USB 1.1. It should be noted that operation is not guaranteed with all computers.

**4: Uses remote-activation from a smartphone. The product does not have a Bluetooth* tethering function.

■ About supported OS
This product can be used on OSs, such as Windows*, Mac*, and Linux, that comply with the 128-bit protocol (with limited to Windows version of OS).

■ About supported browsers
Also, the supported products include the following OS pre-installed products, or products which are guaranteed by manufacturers to use with the following OSs. (Self-made computers are not supported) (As of February, 2020)
Windows 10 supporting:
- Internet Explorer 11.0
- Microsoft Edge
- Internet Explorer 11.0
- Windows 10 supporting:
- Internet Explorer 11.0

■ About supported browsers
Also, the supported products include the following OS pre-installed products, or products which are guaranteed by manufacturers to use with the following OSs. (Self-made computers are not supported) (As of February, 2020)
Android 10/9/8/7/6/5/4/3 supporting:
- Google Chrome
iOS 13/12/11/10/9/8/7/6/5/4/3/2/1/14/13/12/11/10/9/8/7/6/5/4/3/2/1 supporting:
- Safari
- Safari
- Safari

■ Altern is a registered trademark of NEC Corporation. ■ 5G, 4G, 3G, 2G, and CDMA are registered trademarks of NEC Platforms, Ltd. ■ Windows is a registered trademark or trademark of Microsoft Corporation in the United States and/or other countries. ■ Mac, Macintosh, Mac OS, macOS, OS X, iPadOS, AirPods, Apple, iPhone, iPod touch, and Safari are trademarks of Apple Inc., registered in the United States and/or other countries. ■ App Store is a service mark of Apple Inc. ■ The iPhone trademark is used under license from Apple Inc. ■ Internet Explorer is a trademark or registered trademark of Microsoft Corporation in the United States and/or other countries. ■ Google, Android, Google Chrome, and Google Play are trademarks or registered trademarks of Google LLC. ■ Bluetooth and the Bluetooth logo are trademarks registered to Bluetooth SIG, Inc., and are being used under license. ■ "QR Code" is a registered trademark of DENSO WAVE INCORPORATED. ■ Other company names, brand names, service names and so on are trademarks or registered trademarks of their respective owners. TM and the ® mark may be omitted in this manual.

© NEC Platforms, Ltd. 2019. This manual and related software may not be duplicated or altered, nor can duplicate copies be distributed in whole or in part, without prior written permission from NEC Platforms, Ltd.

February, 2020, 1st Edition
LAN TELEPHONE COMPANY
Manufactured by NEC Platforms, Ltd.